

Marine compasses

CMIcompass

Clocks & Meteorology

Compass repair service







Contents

.....



MARINE COMPASSES



CLOCKS & WEATHER
INSTRUMENTS



24/7 QUALITY
REPAIR SERVICE
Anywhere. Anytime.

Share our enthusiasm for accuracy

Welcome to Autonautic

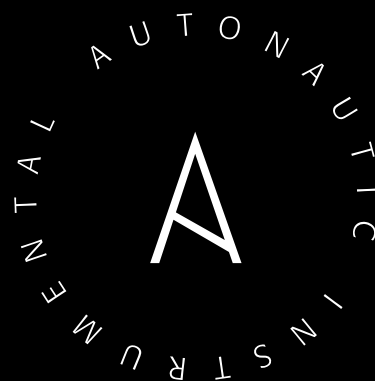

With over 35 years at the forefront in the design and manufacture, our trade is to combine accuracy, solidness and best craftsmanship.

The extensive portfolio of Autonautic Instrumental includes all type of marine compasses, innovative systems for navigation, precise clocks, barometers and weather instruments well balanced up to the detail.

All our marine compasses are in compliance with Directive MED 96/98 EC on Marine equipment and its amendments, to provide you with a compass that guarantees maximum safety in Navigation.

We manufacture a wide range of high quality marine compasses, attractively designed for any type of boat.

The quality of our compasses comes with the endorsement of the most demanding quality control systems of all Autonautic production processes, and the implementation of the ISO 9001:2000 quality system accredited by the authorized agency Bureau Veritas for the design, manufacture and repair service of magnetic compasses.

All our compasses are in compliance with Directive MED 96/98 EC on Marine Equipment, to provide you with a compass that guarantees maximum safety in navigation.

Autonautic clocks, chronometers and weather instruments combine traditional design and the stylishness of the finest nautical clocks and weather instruments.





CERTIFICADO N° 30333/14/AN
CERTIFICATE No.

Se certifica que el Sistema de Gestión de Calidad de
It is hereby certified that the Quality Management System of

AUTONAUTIC INSTRUMENTAL S.L.

C/ ITALIA, 1 08320 EL MASNOU (BARCELONA) ESPAÑA

en las siguientes unidades operativas / in the following operational units

C/ ITALIA, 1 08320 EL MASNOU (BARCELONA) ESPAÑA

cumple con la norma
is in compliance with the standard

ISO 9001:2008

para el siguiente campo de actividades / for the following field of activities

EA-19

DISÑO, FABRICACIÓN Y REPARACIÓN DE COMPASES MAGNÉTICOS PARA LA NAVEGACIÓN MARÍTIMA.

DESIGN, MANUFACTURE AND REPAIR SERVICES OF SHIP AND BOAT COMPASSES.

La validez de este certificado depende de las auditorías semestrales / anuales y revisión completa cada tres años del Sistema de Gestión
The validity of this certificate is dependent on an annual / six monthly audit and on a complete review, every three years, of the management system
 El uso y validez de este certificado está sujeto al cumplimiento de los documentos RINA: Reglamento para la Certificación de Sistemas de Gestión de Calidad
The use and validity of this certificate are subject to compliance with the RINA document: Rules for the certification of Quality Management Systems

Primera emisión
First Issue 07.03.2014
 Emisión corriente
Current Issue 14.03.2014
 Fecha de vencimiento
Expiry Date 06.03.2015

Ing. Michele Francioni
 (Chief Executive Officer)

RINA Services S.p.A.
 Via Corsica 12 - 16128 Genova Italy

CISQ es la Federación Italiana
 de Entes de Certificación del
 Sistema de Gestión

CISQ is the Italian
 Federation of management
 system Certification Bodies







PRODUCT QUALITY ASSURANCE (MODULE D)
CERTIFICATE No. MED059913XA

This is to certify that RINA, specified in Notified Body N° 0474 by the Italian "Ministero della Infrastruttura e dei Trasporti Direzione Generale per la navigazione ed il Trasporto Marittimo ed Isolare" on 23 November 1998, did undertake the examination of the equipment identified below with the criteria set-up in Annex B (Production Quality Assurance-Module D) to Marine Equipment Directive (MED) 96/98/EC, and subsequent amendments.

MED Item N°	A.114.23
Description	Compass for lifeboats and rescue boats
Type	C10/C08C; C12/C12-110/C4/C12 PLUS; C15/C15-150;
	CHB/C5B/CHH; CHE
Applicant	AUTONAUTIC INSTRUMENTAL S.L.
	C/ ITALIA
	5
	08320 EL MASNOU (BARCELONA)
	SPAIN
Module B certificate	Number MED061214CS/002
	Date 20/03/2014
	Notified Body RINA (No.0474)

Issued on 04/03/2014 on April 3, 2014

This Certificate is valid until April 1, 2017.

On the basis of the conditions stated in article 11 of the Marine Equipment Directive (MED) 96/98/EC, this certificate allows the Manufacturer to affix the following symbol on the equipment where identified

 **0474/YY**

See two signs of your mark affixed



Cristina Melado Henriquez
 RINA Services S.p.A.

RINA Services S.p.A.
 Via Corsica 12 - 16128 Genova
 Tel: +39 010 55551
 Fax: +39 010 5555100

Reinventing deviaton certificate

10.4" CMIcompass Touch Screen TFT display

The TFT Touch Screen display comes with a robust bracket for roof or stand mount.



An innovative concept in navigation equipment...

► Obtain the True Course derived from your Magnetic Compass

This is the first equipment in the history of navigation able to provide the autopilot with the True Course signal derived from the magnetic compass processed and corrected in real time.

► Global multiple heading reference management system

Select the current heading from all available heading sources on the TFT TouchScreen and provide added value to numerous current navigation and marine safety equipment such as repeaters, autopilots, radars, ECDIS, VDR, etc.

► Accuracy and Precision of the information

The real-time processing of the system generates the deviation table providing equipment with a level of accuracy and precision never seen until now. The result is that ship owners can more easily meet the new demands required by international administrations.

► Print the Magnetic Course deviation table

Never been so easy to get it!

Equipment uses a computing system, the information from the magnetic compass, derived electronically, and other THD sources and published magnetic data to obtain the deviation table for the master compass of a ship in real time.

► Easy to operate

Touch screen technology, with a super intuitive well-designed human interface presents all the information through the use of various menus.

► Optimisation of the time-cost in the compass adjustment

The use of a CMI compass offers opportunities for considerable operational savings for both the ship-owner and vessel charterer.



Obtain the True Course derived from your Magnetic Compass

This is the first equipment in the history of navigation able to provide the autopilot with the True Course signal derived from the magnetic compass processed and corrected in real time.



Global multiple heading reference management system

Select the current heading from all available heading sources on the TFT TouchScreen and provide added value to numerous current navigation and marine safety equipment such as repeaters, autopilots, radars, ECDIS, VDR, etc.



Accuracy and Precision of the information

The real-time processing of the system generates the deviation table providing equipment with a level of accuracy and precision never seen until now. The result is that ship owners can more easily meet the new demands required by international administrations.



Print the Magnetic Course deviation table

Never been so easy to get it!

Equipment uses a computing system, the information from the magnetic compass, derived electronically, and other THD sources and published magnetic data to obtain the deviation table for the master compass of a ship in real time.



Easy to operate

Touch screen technology, with a super intuitive well-designed human interface presents all the information through the use of various menus.



Optimisation of the time-cost in the compass adjustment

The use of a CMI compass offers opportunities for considerable operational savings for both the ship-owner and vessel charterer.



COMPASSES



Here is our smallest compass and ideally suited for use in a RIB or dinghy. When making your selection there are essentially three criteria size, damping and style of the compass card. This C3 compass is easily mounted on a flat surface so no hole is required. It is well damped to cope with the greater range of movement in a RIB or dinghy and features a spherical card that is easy to read when standing up or sitting down.

Small, tidy and perfectly formed



C3001



C3002

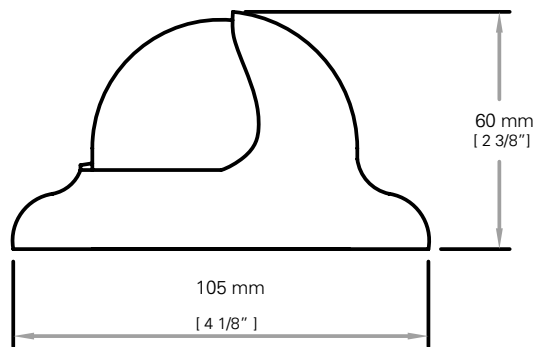

Compass type	Surface mount
Boat Style	RIB or dinghy
Dial Size	65 mm
Card design	Conical
Night Lightning	12- 24 V
Compensators	NO
Warranty	2 years

COMPASS C12 SERIES



001



002



003

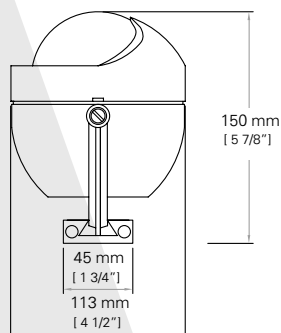
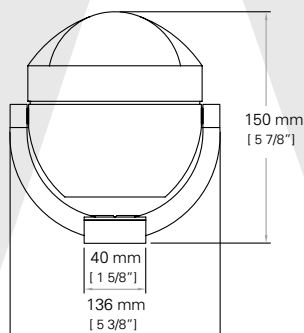

004



005

Compass type	Bracket mount
Dial size	85 mm
Card design	Flat or black cone-shaped card
Night Lightning	12- 24 V
Compensators	Optional
Warranty	5 years

Compliant with MED96/98 EC



0474-XX

COMPASS C12 PLUS SERIES

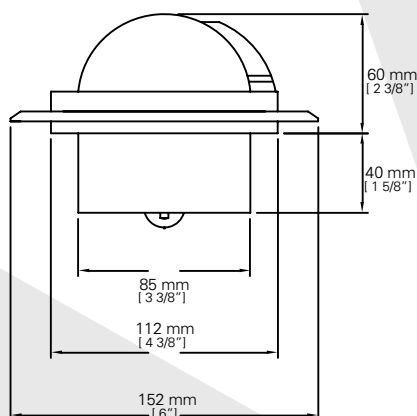

0020



0021

	Ref. 0020	Ref. 0021
Compass type	Flush mount	
Boat style, size	Power or sail	
Dial size	85 mm	100 mm
Card design	Flat	
Night Lightning	12- 24 V	
Compensators	Optional	
Protective cover	Yes	
Mounting hole	85 mm	100 mm
Warranty	5 years	

Compliant with MED96/98 EC



0474-XX

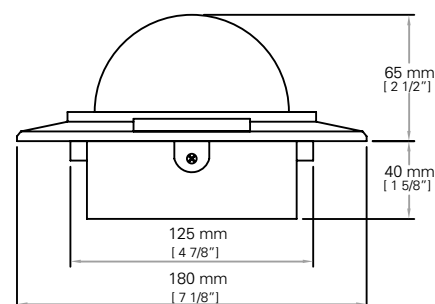



**Flush mount compasses with
a clear looking desing**

COMPASS C12 110 SERIES



0010



0011



0012



0013



0014



0015



0016

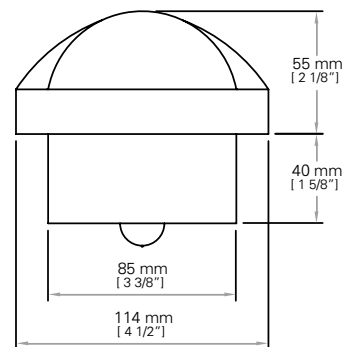

Compass type	Flush mount
Boat Style	Power or sail
Dial Size	85 mm
Card design	Flat or Conical
Night Lightning	12- 24 V
Compensators	NO
Mounting hole	85 mm
Warranty	5 years

Compliant with MED96/98 EC





0025

Lateral mount



0026

Roofmount

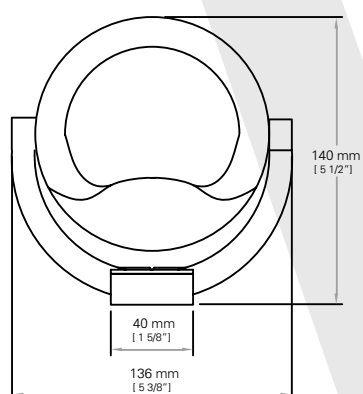

0474-XX

Compliant with MED96/98 EC

Ref. 0025 / 0026	
Compass type	Multidirectional bracket mount
Boat Style	Power or sail
Dial Size	85 mm
Card design	Conical
Night Lightning	12- 24 V
Clinometer	5°
Compensators	Optional
Warranty	5 years



0027

Roofmount

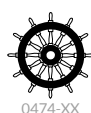
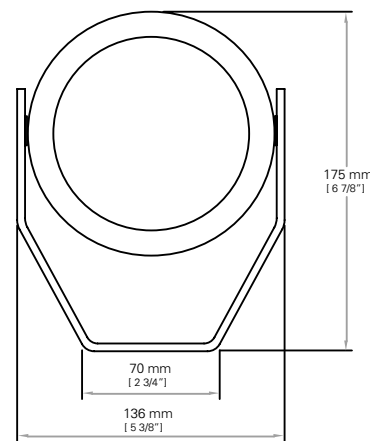

0474-XX

Compliant with MED96/98 EC

Ref. 0027	
Compass type	Bracket mount
Boat Style	Power or sail
Dial Size	100 mm
Card design	Conical
Night Lightning	12- 24 V
Clinometer	5°
Compensators	Optional
Warranty	5 years



COMPASS C10 SERIES



0037

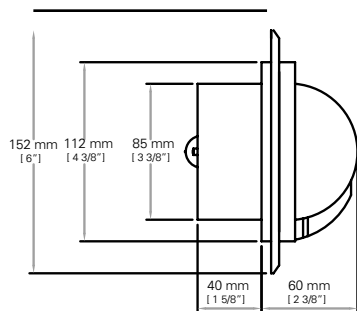

0038

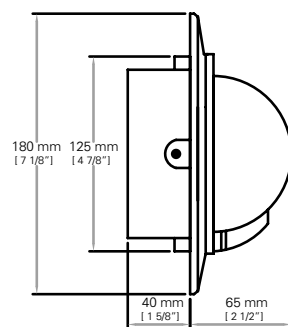

	Ref. 0037	Ref. 0038
Compass type	Bulkhead mount	
Boat Style	Sail / Vela	
Dial Size	85 mm	100 mm
Card design	Conical	
Night Lightning	12- 24 V	
Clinometer	5°	
Protection cover	Yes	
Mounting hole	85 mm	125 mm
Warranty	5 years	

Compliant with MED96/98 EC



COMPASS C9 SERIES



0030



0031

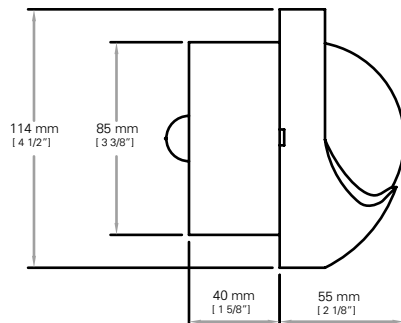

Compass type	Bulkhead mount
Boat Style	Sail
Dial Size	85 mm
Card design	Conical
Night Lightning	12- 24 V
Clinometer	5°
Mounting hole	85 mm
Warranty	5 years

Compliant with MED96/98 EC

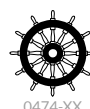

COMPASS C-15 SERIES



0048



0049



0050

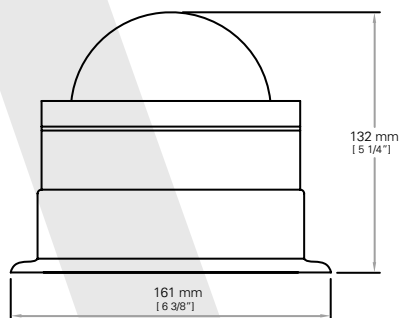

0051



0052



0474-XX

Compliant with MED96/98 EC

Compass type	Deck mount
Boat Style	Power or sail
Dial Size	100 mm
Card design	Flat or Conical
Night Lighting	12- 24 V
Compensators	Built-in
Protection cover	Yes
Warranty	5 years

COMPASS C-15 150 SERIES

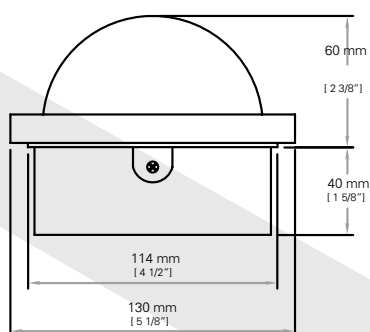

0065



0064



0063

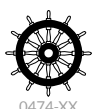

0474-XX

Compliant with MED96/98 EC

Compass type	Flush mount
Boat Style	Power or sail
Dial Size	100 mm
Card design	Flat or Conical
Night Lighting	12- 24 V
Compensators	NO
Protection cover	Yes
Mounting hole	85 mm
Warranty	5 years



CHE SERIES



0073



0074

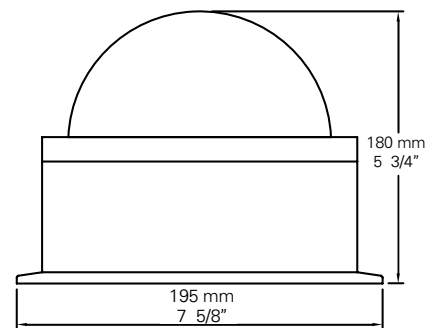

0073 / 0074



0075



0076

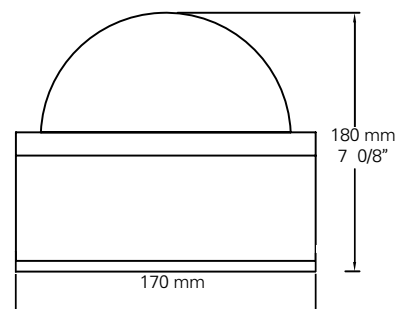

0075 / 0076

Compass type	Deck mount
Boat Style	Power or sail
Dial Size	140 mm
Card design	Flat
Night Lightning	12- 24 V
Compensators	Built-in
Protection cover	Yes
Warranty	5 years

Compliant with MED96/98 EC





**Binnacle mount compass 140 mm dial
with D correctors for steel hulled boats**



0077

140 mm 5,75" dial
B + C correctors built-in
D-correctors with brackets for steel hull vessels
Hardened Steel Pivot and Sapphire Jewel
90 degree Lubber Lines for easy reading
Night lightning 12 / 24 V
Easy maintenance ABS binnacle
Type MED / SOLAS approved
Exclusive 5 Years warranty
Dimensions: 195mm base / 180 mm high





***Overhead compass for
use on professional or commercial ships***



0078

Compliant with MED96/98 EC

125 mm card
B correctors built-in
Night lighting 12 / 24 V
Type MED / SOLAS approved
Individual MED / SOLAS certificate included
5 Years warranty

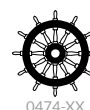



Wooden box Rescue boat compasses



COMPASS C4 SERIES

	Ref. 0114	Ref. 0108
Compass type	Wooden box gimballed compass	
Boat Style	Rescue boats	
Dial Size	100 mm	85 mm
Card design	Flat	
Night Lightning	No	1.5 V LED light
Box dimensions	190x 190x 130 mm	155 x 135 x 155 mm
Warranty	5 years	

COMPASS CHH SERIES

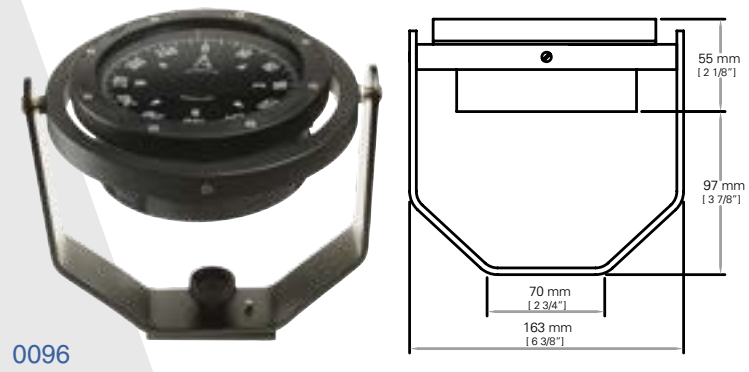
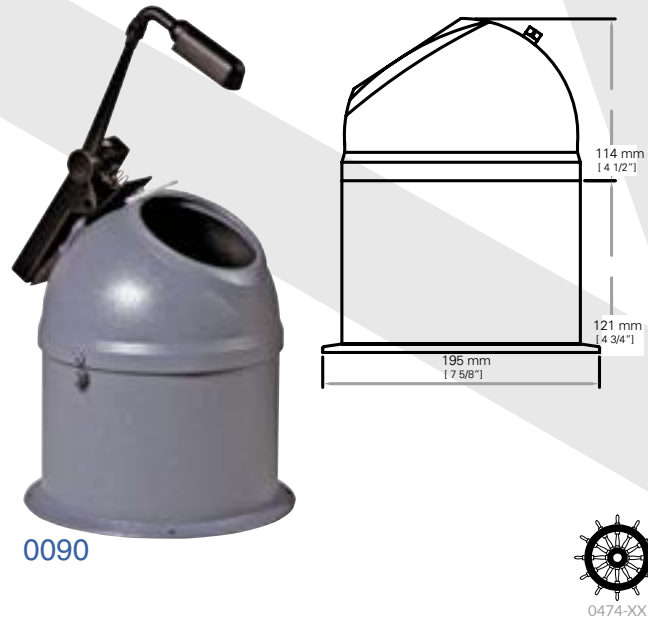

	Ref. 0096
Compass type	Bracket mount
Boat Style	Power
Dial Size	100 mm
Card design	Flat
Gimbal	360°
Warranty	5 years

Marine professional Pelorus

Watch relative bearings change, predict crossing situations, plot offshore fixes with a 3 arm protractor, or check your compass by sun or stars. These are some of the things you can do with a pelorus. Large ships have permanently mounted peloruses, or some that can be mounted in deck shoes. On a smaller scale, these portable peloruses will give you many of the same benefits. A compass adjuster will find this a very nice instrument when calling on an assignment.

Professional grade pelorus



00122

The Boxed Pelorus is stored in its plywood box by resting on two lower gimbals and folding down the aluminium sighting vanes. For operational use, the pelorus is raised to engage two upper gimbals in the box and raising the sighting vanes or installing the sun shadow vane. The plywood box size is 21 x 21 x 18 cm and is finished in natural wood tones.

The Peloruses have a gimballed bearing card which is 125 mm in diameter, and is marked in one degree increments. A sun shadow vane may be used for checking the ship's compass. The gimbals are weighted for stability, and overall construction is of aluminium and polyamide.

Bracket mount pelorus



00123

The Shoe Mount Pelorus comes with a deck shoe that can be affixed with two screws at a desired location where bearings may be easily taken. The pelorus can be taken from its storage box and be quickly mounted on the shoe. After use it can be returned to its box, or left out for later use. Storage box size is 9.5" square x 5" high, and is finished in natural wood tones.

The Pelorus have a gimballed bearing card which is 5 inches in diameter, and is marked in one degree increments. A sun shadow vane may be used for checking the ship's compass. The gimbals are weighted for stability, and overall construction is of aluminum and polyamide.

The Boxed Pelorus is quite nice looking in its box. Apart from its functional attributes, it would be well suited as a marine artifact in a den or office.



Wooden box spare compass Class A
125 mm dial for commercial and professional vessels

COMPASS C-20 SERIES



00131

Compliant with MED96/98 EC

Boat Style	Commercial and professional vessels
Dial Size	125 mm
Card design	Flat
Graduation	Every degree with cardinal markings
Wooden box dimensions	245mm x 245 mm x 135 mm
Protection cover	Yes
Warranty	10 years

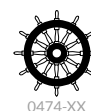

0474-XX

AUTONAUTIC INSTRUMENTAL



COMPASS C-20 SERIES



00137

Arrangements for Autonautic NMEA0183 pick up

Compass types	Bracket mount
Boat Style	Commercial vessels
Dial Size	125 mm
Card design	Flat
Graduation	Every degree with cardinal markings
Overall dimensions	200 mm x 230 mm
Base	140mm
Warranty	10 years

Compliant with MED96/98 EC



For commercial vessels under 150grt, fishing vessels and workboats under 35 metres.



00130

Features:

- Reduced shipyard installation work.
- Arrangements for Autonautic NMEA0183 TMC sensor.
- Simple periscope assembly installation and removal.
- B+C compensation system built-in.
- Low weight.
- Reinforced ABS binnacle.
- Two LED lights lamps fitted within the binnacle

OPTIONAL ACCESSORIES / ACCESORIOS - NMEA0183 TMC SENSOR (REF. C20-00132) - AZIMUTH RING AND Sighting Vanes (REF C20-00136)

Periscope tube
(included)

Features:

- Reduced shipyard installation work.
- 30° of Visibility.
- Optimal individually length arrangements.
- Anti-Reflective lens
- Low weight.
- Reinforced ABS periscope.



Waterproof cover
(included)

Features:

- Improved protection.
- Plastic PVC canvas.



Light junction box
(included)

Features:

- High quality LED lighting.
- 3,5 V / 24 Vdc.
- Main and emergency light.
- IP rating 67.



Spare compass fitted with Azimuth ring and sighting vanes





For commercial vessels, fishing vessels and workboats under 35 metres.
Table top or reflector compass for aluminium / steel hull

Features:

- Reduced shipyard installation work.
- Arrangements for Autonautic NMEA0183 TMC sensor.
- Class A 125 mm magnetic compass.
- 1 degree graduation.
- Low weight.
- Reinforced ABS binnacle.
- 24 dvc. lighting.
- Quadrantal corrector for steel hull.
- Waterproof canvas cover.

Optional accessories:

- Periscope. C20-00135
- NMEA0183 TMC sensor. C20-00132
- Spare 125 mm compass. C20-00131



0474-XX



00128

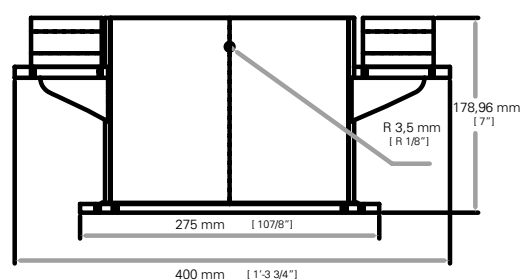

NMEA0183 Transmitting magnetic compass

The Autonautic Transmitting Magnetic Compass (TMC) is based on our very successful C20 compasses. Many users still want the reassurance of a traditional magnetic compass but with it coupled to their electronic systems. Makes sense, because it is a very robust strategy. The encoder, which is mapped to the compass card, only needs to be connected to a 12 or 24 volt supply and to a NMEA0183 input on a suitable system.

This approach is much more accurate than the traditional coils that are attached to the compass. Once installed it is ready to go. No further set up is required and because the encoder reads the compass card heading so the synchronisation between the card and NMEA sentence is preserved even after the compass has been swung.

This NMEA compass pickup coil is fitted underneath one of our externally gimballed compasses converting it to a Transmitting Magnetic Compass (TMC) with direct NMEA0183 capability.

The pickup senses the magnetic field and generates a NMEA0183 \$HCHDG sentence.

The TMC is ready to work once power is applied and only needs connecting to a NMEA0183 receiving device. This significantly simplifies and speeds up installation time for a TMC.

The compass can then be compensated as normal and since the TMC is aligned to the compass card the HDG reading will always match the compass card reading.

These pickups are installed and aligned to the compass in our workshop and supplied for connection to your intended system without any extra cost.

The TMC pickups can be attached to any of the Autonautic Instrumental gimballed compasses.



Typical applications include

- Compass heading for a NMEA0183 Display.
- Driving multiple compass displays.
- Autopilot heading.
- Chart plotting and navigation data source.

Features

- Supply requirements +8 to +30 Volt @ 25mA.
- Heading data format NMEA 0183 (\$HCHDG) at 10Hz rate.
- Warranty 2 years.
- Termination Junction box near compass IP rating IP67.
- Repairable No.



Typical applications

Autonautic C20-00128 fitted with NMEA 0183 pickup coil

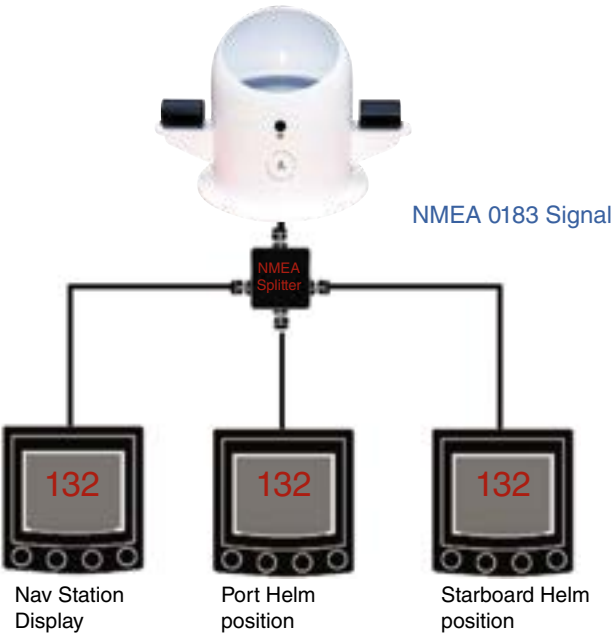

Autonautic C20-00128 fitted with NMEA 0183 pickup coil



CLOCKS & METEOROLOGY



Automatic

Base 72 mm / Top height 39 mm / Dial 50 mm	
R 72D	Quartz clock
B 72D	Baromete
T 72D	Thermometer
H 72D	Higrometer
R 72C	Quartz clock
B 72C	Baromete
R 72C	Quartz clock
H 72C	Higromete
RE 72	Quartz clock
BE 72C	Barometer
TE 72C	Thermometer
HE 72C	Higrometer
B 72N	Barometer
T 72N	Thermometer
H 72N	Higrometer



R 72D



B 72D



T 72D



H 72D



R 72C



B 72C



T 72C



H 72C



R 72N



B 72N



T 72N



H 72N



RE 72C



BE 72C



TE 72C



HE 72C

MINOR 72 SERIES



E72H

Base	72 mm	Weather stations outdoor / indoor use
Top height	39 mm	
Dial	50 mm	
E 72H	240 x 120 mm	E 72 H
E 72V (Vertical)	120 x 240 mm	E 72 V

.....



EP



EPC

Base	72 mm	Weather stations
Top height	39 mm	
Dial	50 mm	
EP	230 x 85 mm	
EPC	230 x 85 mm	



SP



SPD

Base	72 mm	Tableclock
Top height	39 mm	
Dial	50 mm	
SP	82 x 60 mm	
SPD	157 x 60 mm	

.....



R95P



B95P

Base	95 mm	/	Top height	35 mm	/	Dial	70 mm
R 95P	30 x 130 mm						
B 95P	130 x 130 mm						

Base 95 mm / Top height 35 mm / Esfera Dial 70 mm	
R 95D	Quartz clock
B 95D	Baromete
T 95D	Thermometer
H 95D	Higrometer
R 95C	Quartz clock
B 95C	Baromete
T 95C	Thermometer
H 95C	Higromete
R 95N	Quartz clock
B 95N	Barometer
T 95N	Thermometer
H 95N	Higrometer

.....



R95D



B95D



T95D



H95D



R95C



B95C



T95C



H95C



R95N



B95N



T95N



H95N



EC



EG



EGC

Base	95 mm	Weather stations
Top height	35 mm	
Dial	70 mm	
EC	Quartz clock	240 x 240 mm
EG	Barometer	350 x 130 mm
EGC	Thermometer	350 x 130 mm
ED	Higrometer	240 x 130 mm



E95H



ED



EMM

Base	118 mm	Weather station outdoor / indoor use with max-min. funktion
Top height	24 mm	
Dial	71 mm	
E 95H		330 x 135 mm
E 95V (Vertical)		330 x 135 mm
EMM		160 x 200 mm

ATLANTINC 95 SERIES



EMR



EMD



EMT

Base	118 mm	Weather stations
Top height	24 mm	
Dial	71 mm	
EMR		330 x 280 mm
EMT		443 x 185 mm
EMD		290 x 130 mm

PACIFIC 120 SERIES



DEM

Base	118 mm	Weather stations
Top height	24 mm	
Dial	71 mm	
DEM		360 x 160 mm



R120D



R1200C



R1200N



B120D



B120C



CL120D



Wall mounting ring included

Base 120 mm / Top height 35 mm / Dial 95 mm		
R 120D		Quartz clock
B 120D		Baro/Termo
R 120C		Quartz clock
B 120C		Baro/Termo
R 120N		Quartz clock
B 120N		Baro/Termo
CL120D		Clinometer

IEM



RBS



Base	118 mm	Ship's bell clock
Top height	24 mm	
Dial	95 mm	
PCP		300 x 160 mm
IEM		315 x 160 mm
RBS		200 x 160 mm

BALTIC 110 SERIES



RBP



BBP



HBP



TBP



00101

Base	110 mm	Weather stations
Top height	40 mm	
Dial	100 mm	
RBP	Quartz clock	
BBP	Barometer	
TBP	Thermometer	
HBP	Higrometer	
00101	Clinometer	



E110

Base	118 mm	Weather stations outdoor / indoor use
Top height	24 mm	
Dial	71 mm	
E 72H		405 x 180 mm



R220D



B220D



R220C



B220C



Wall mounting ring included

Base 220 mm / Top height 85 mm / Dial 150 mm	
R 220D	Quartz clock
B 220D	Baro/Termo
R 220C	Quartz clock
B 220C	Baro/Termo



RPM



EMP

Base 220 mm / Top height 85 mm / Dial 150 mm	
EMP	530 x 290 mm
RMP	290 x 290 mm

ADRIATIC 220 SERIES



E200P



R200D



E200N



DEG



E200D

Base	200 mm	Weather stations with clock, thermometer, barometer and higrometer
Top height	50 mm	
Dial	160 mm	
DEG	480 x 230 mm	
E 200D	Quartz clock	
R 200D	Barometer - Thermometer	
E 200N	Quartz clock	
E 200D	Barometer - Thermometer	

We have developed this chronometer to recall the look of the original ships chronometers. Gimballed Marine chronometers in wooden box with gold plated hinges, handles, corner protectors and bowl.



CMS

Marine professional quartz chronometer. The wooden box is made from fine grade beechwood with a mahogant finish.

Fully gimballed clock made with gold plated solid brass.

Movement Specifications:

- Battery: Mignon cell IEC (AA)
- Quartz frequency: 32.786 KHz
- Operation Voltage: 1.2V - 1.7V
- Time Keeping Accuracy: Din 8325
- Operating Temperature range: - 5.C + 50.C
- Battery Life: Approx 1 year

Dimensions:

200 x 200 x 85 mm

200 x 200 x 105 mm

CSQ

Marine quartz chronometers



CSQ

200 x 200 x 105 mm



Marine quartz chronometers

Marine professional quartz chronometer. The wooden box is made from fine grade beechwood with a mahogant finish and glod plated brass fittings.

The clock is on a inclined bed for easy viewing with the top opened, or even with it closed due to the clearpanel mounted in the top.

Gold plated brass clock case.

Movement Specifications:

- Battery:: Mignon cell IEC (AA)
- Quartz frequency: 32.786 KHz
- Operation Voltage: 1.2V - 1.7V
- Time Keeping Accuracy: Din 8325
- Operating Temperature range: -5C° +50C°
- Bettery Life: Approx 1 year

Dimensions:

195 x 195 x 185 mm.



CMQ

MAGNETIC COMPASS

REPAIR SERVICE

With routine maintenance, we can ensure that your vessels will have a standard magnetic compass on which they can rely, in any situation.

Autonautic provides ships compass surveys, compass adjusting services, replacement and installation on-board your vessel. Within the shortest time, no matter where you are.

Autonautic is the only company worldwide with the ISO 9001:2000 for magnetic compass repair services.

RINA certifies our compass repair process with the ISO 9001:2000 quality certification and RINA service supplier for magnetic compass servicing.

Over 4.000 Repairs and a profound knowledge of compass manufacturing provide us with the required experience to repair any type of compass with total confidence.



SERVICE SUPPLIER

RINA

Autonautic are recognized by RINA services for magnetic compass servicing.

Our service and repair centre in Barcelona is fully equipped to carry out the 4 or 2 years overhaul to issue RINA certificates for Italian flag vessels.

Over 4.000 Repairs and a profound knowledge of compass manufacturing provide us with the required experience to repair any type of compass with total confidence.



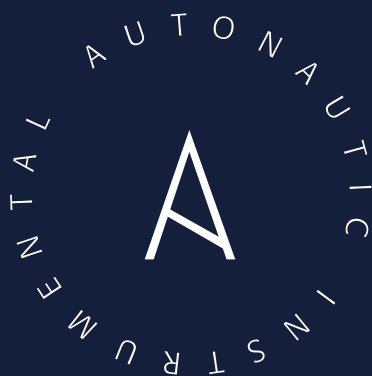

T +34 93 540 99 49 · F +34 93 540 99 51

info@autonauticainstrumental.com

www.autonauticainstrumental.com

Italia 1, 08320 El Masnou, Spain

